



# JOHN DEERE TECH PROGRAM



# Introduction

The John Deere TECH Program is a concentration that is part of the Agricultural Power Machinery and Diesel Technology degrees. A successful graduate of this program will be granted an Associate in Applied Science degree.

The curriculum will emphasize the development of technical competencies and professional abilities needed for a beginning dealership service technician.

The curriculum content will be designed in cooperation with John Deere Company and SUNY Cobleskill Ag & Tech. The student will attend both classroom lectures and specific laboratory sections which will concentrate both on diagnosis and repair of John Deere equipment. This program will provide a unique opportunity for students to work at their sponsoring dealership as an employee.

The degree program is completed in 21 months. Four semesters are spent in school and a minimum of 600 hours in the sponsoring John Deere dealership. The student will be involved in a paid work experience. This work experience will happen during the semester, school breaks, and summer vacation to support what the student is learning in lectures and labs.

The work experience can have a powerful impact on student success; therefore, the dealer sponsorship is essential to this program.

Dealers are responsible for providing students with training-related employment during the work experience periods. Students are responsible for tuition, fees and textbook costs.

Students are required to obtain a sponsor from an authorized John Deere dealership. Students can request assistance in locating a sponsoring dealer and dealers can request assistance in locating a student to sponsor.

Visit [deere.com/powerup](https://deere.com/powerup) for more information on the John Deere TECH Program. To find a local John Deere dealer, use the dealer locator at [dealerlocator.deere.com](https://dealerlocator.deere.com).

---

## Directions to Cobleskill Ag & Tech

- From Buffalo, Rochester and Syracuse, take NYS Thruway (Interstate 90) to Exit 29 at Canajoharie. Proceed south on Route 10 to Cobleskill.
- From Binghamton or Albany areas, take Interstate 88 to Cobleskill (Exit 21).
- From Watertown, take Interstate 81 to Syracuse and then follow above directions from Syracuse.
- From Plattsburgh, take Interstate 87 south to Albany; proceed west on Interstate 90 to Exit 25A; follow Interstate 88 to Cobleskill at Exit 21.
- From New York City and Long Island, take NYS Thruway (Interstate 87 north to Albany, then Interstate 90 west). For a short cut through the mountains (not advised during inclement weather), take NYS Thruway (Interstate 87) north to Exit 21 at Cobleskill. Follow Route 23 west for about 8 miles to the junction of Route 145. Take Route 145 to Route 7; follow Route 7 west to the campus.

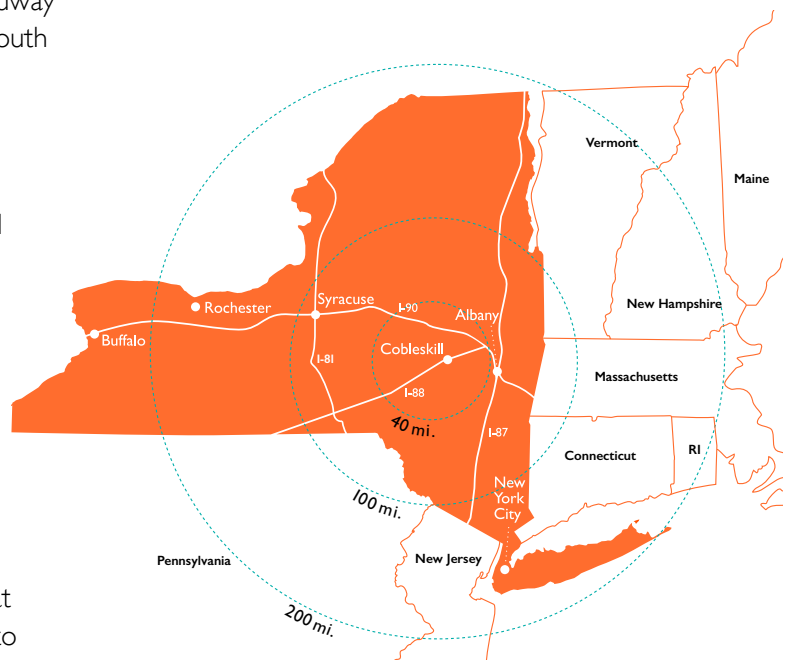

# Participant Responsibilities

The John Deere TECH Program is a partnership program between the John Deere Company, SUNY Cobleskill Ag & Tech, participating John Deere dealerships and participating students. Each have the following responsibilities in this partnership:

## John Deere Company

- Encourage dealer cooperation and support
- Provide John Deere training for all the program instructors
- Furnish the college with John Deere training equipment (manuals, components, essential tools and brand new equipment)
- Provide the college with essential training materials including technical publications and training aids
- Participate in student selection procedure
- Monitor all phases of John Deere TECH to ensure success

## John Deere Dealership

- Indicates interest in being a sponsoring dealer so dealership name can be available to interested students
- Interview and select a student that the dealership will sponsor
- Actively recruit students for the program
- Appoint an in-dealership coordinator to assist the college in planning and monitoring the work experiences
- Provide appropriate work experiences which reinforces the students' most recent classroom instruction
- Pay students during periods of dealership work experience
- Provide student/employee with uniforms consistent with other dealership employees
- Provide sponsored students with their own individual user ID and password to access John Deere software

Some dealers may also provide students with the following:

- Tuition assistance programs
- Tool programs
- Laptop with diagnostic software
- Other employee benefits

## Cobleskill Ag & Tech

- Maintain a current curriculum articulated with John Deere
- Provide adequate classroom and laboratory facilities
- Provide a Program Coordinator who will act as a liaison between the college and the John Deere Company
- Pay the regular salary of the college instructors and provide reasonable travel expenses associated with instructor training
- Provide students with the basic shop equipment and tools to be used in the laboratory
- Promote, advertise, and recruit qualified student candidates based on the college's academic standards and in consultation with John Deere Company
- Assist dealers with student selection for the program
- Maintain all student records
- Provide student services such as academic, financial aid, counseling, etc
- Design a curriculum allowing for a minimum of 600 hours of educational work experience during the semester and/or school breaks
- Conduct visitation(s) during the student work experience
- Work with the dealership to assure attainment of desirable work experience competencies



Photo courtesy of John Deere Company

## Student

- Meet a specified admission and academic requirement established by the college
- Obtain and maintain sponsorship with their John Deere dealership
- Maintain academic standards and adhere to academic and dealership policies
- Maintain attendance standards according to college policy
- Provide sponsoring dealer with responsible and productive employment
- Be responsible for program costs (such as tuition, books, fees and tools)
- Provide their own tools while completing dealership work experiences

## Work Experience

Students will be required to complete work experience hours at their sponsor dealership as part of the curriculum and during the school breaks.

- Fall Semester 1: 25 hours minimum
- Winter Break 1: 40 hours minimum
- Spring Semester 1: 40 hours minimum
- Summer Break: 400 hours minimum
- Fall Semester 2: 40 hours minimum
- Winter Break 2: 40 hours minimum
- Spring Semester 2: 30 hours minimum

**Total: 615 hours minimum**

*\*Minimum hours could change based on program needs*



Photo courtesy of John Deere Company

# Agricultural Power Machinery - Ag/Turf Dealers

## Associate in Applied Science (Curriculum Code - 0506)

Modern agriculture demands skilled technicians who have an understanding of the complex designs and applications of power machinery. The Agricultural Power Machinery major deals with the techniques of servicing and selling farm machinery and tractors. Students develop basic working skills in the mechanics of gas and diesel power units, field machines, hydraulics, transmissions and final drives, as well as diesel engines, power trains, computerized controllers, electronics, and mobile air conditioning as they pertain to modern tractors. Additional course work specializes in tillage, planting, harvesting, and materials handling equipment. Extensive use of electronic technical manuals, computerized testing procedures, and Global Positioning are incorporated in the curriculum. Practical knowledge of agriculture coupled with general management practices will prepare students for employment with farms, agricultural equipment dealerships and companies for management, sales, parts and service positions. The Agricultural Power Machinery Degree is accredited by the Associated Equipment Distributors (AED) Foundation.

### Degree Requirements

To fulfill requirements for the Associate in Applied Science degree, the candidate in the field of Agricultural Power Machinery - John Deere TECH concentration must complete a minimum of 60 credit hours of academic work with a GPA of not less than 2.00. These credits include 34 credits of major field requirements and 20 credits in prescribed areas of liberal arts and sciences and specialization requirements. The remaining 6 credits are accomplished through work experience, specialized instruction, and electives.

### Major Field Requirements

	Credits
<b>AGEN 111</b> Fundamentals of Computing in Equipment Technology	2
<b>AGEN 132</b> Fundamentals of Diesel Engine Technology	3
<b>AGEN 151</b> Introduction to Welding	2
<b>AGEN 166</b> Fundamentals of Equipment Mechanics	2
<b>AGEN 170</b> Introduction to Fluid Power	3
<b>AGEN 231</b> Electrical and Electronic Systems Diagnostics	3
<b>AGEN 232</b> Power Train Theory, Diagnostics & Repair	4
<b>AGEN 241</b> Agricultural Machinery	4
<b>AGEN 245</b> Mobile Vehicle HVAC	2
<b>AGEN 273</b> Fluid Power & Hydrostatic Diagnostics	3
<b>AGEN 285</b> Equipment Retailing Management	3
<b>AGEN 292</b> Fuel System Theory, Diagnostics & Repair	3
Total	34

### Liberal Arts and Sciences Requirements

	Credits
<b>English</b> (excludes ENGL 100 and must include ENGL 101)	6
<b>Science/Mathematics</b> Any BIOL, CHEM, PSCI, PHYS, or MATH III or higher course (PHYS 101 is Required)	7
<b>PHED/Wellness</b>	1
Additional courses to total 6 credits, to be selected from the Trustees' General Education Core Requirement	6
Total	20
<b>Additional Requirements</b> Foundations for College Success	1
<b>John Deere AG TECH</b> <i>Specialization Requirements</i>	
<b>AGEN 007</b> John Deere Work Experience	0
<b>AGEN 116, 117, 118, 119</b> Manufacturer Specific Orientation/Training	4
<b>AGEN Elective</b>	1
<b>Total Credits</b>	<b>60</b>

\* Refer to the college catalog for up to date program information and course descriptions.

# Diesel Technology - Construction/Forestry Dealers

## Associate in Applied Science (Curriculum Code - 0672)

Today's power market is almost exclusively diesel-fueled from 20 to more than 55,000 horsepower. The need for diesel technicians is rapidly increasing, with growing applications in automotive, light trucking and in the lawn and garden equipment fields. Coupled with the strong market applications to meet the industrial, trucking, construction, power generator and agricultural needs, the expanding technology in engines and fuel systems requires trained technicians to maintain them. Courses in System Fundamentals, Nozzles and Injectors, and Diesel Fuel Injection Pumps are complemented with electrical, hydraulic, welding, engine overhaul and transmission education. Courses offered at SUNY Cobleskill require much hands-on training so each student may develop those skills necessary to meet current and future challenges. Students successfully completing the program are highly sought after technicians with the skills to be successful in the industry. The Diesel Technology program has recently been further enhanced by being accredited by the Associated Equipment Distributors (AED).

### Degree Requirements

To fulfill requirements for the Associate in Applied Science degree, the candidate in the field of Diesel Technology - John Deere TECH concentration must complete a minimum of 60 credit hours of academic work with a GPA of 2.00 or greater. These credits include 40 credits of major field requirements and 20 credits in prescribed areas of liberal arts and sciences.

#### Major Field Requirements

	Credits
AGEN 111 Fundamentals of Computing in Equipment Technology	2
AGEN 132 Fundamentals of Diesel Engine Technology	3
AGEN 151 Introduction to Welding	2
AGEN 166 Fundamentals of Equipment Mechanics	2
AGEN 170 Introduction to Fluid Power	3
AGEN 231 Electrical and Electronic Systems Diagnostics	3
AGEN 232 Power Train Theory, Diagnostics & Repair	4
AGEN 245 Mobile Vehicle HVAC	2
AGEN 273 Fluid Power & Hydrostatic Diagnostics	3
AGEN 274 Construction Equipment Systems	3
AGEN 285 Equipment Retailing Management	3
AGEN 292 Fuel System Theory, Diagnostics & Repair	3
<b>Total</b>	<b>33</b>

#### Liberal Arts and Sciences Requirements

	Credits
<b>English</b> (excludes ENGL 100 and must include ENGL 101)	<b>6</b>
<b>Science/Mathematics</b> Any BIOL, CHEM, PSCI, PHYS, or MATH III or higher course (PHYS 101 is Required)	<b>7</b>
<b>PHED/Wellness</b>	<b>1</b>
Additional courses to total 6 credits, to be selected from the Trustees' General Education Core Requirement	<b>6</b>
	<b>20</b>
<b>Additional Requirements</b>	
Foundations for College Success	1
<b>John Deere AG TECH</b> Specialization Requirements	
<b>AGEN 007</b> John Deere Work Experience	<b>0</b>
<b>AGEN 116, 117, 118, 119</b> Manufacturer Specific Orientation/Training	<b>4</b>
<b>AGEN Elective</b> (not 105 and 261)	<b>2</b>
<b>Total Credits</b>	<b>60</b>

\* Refer to the college catalog for up to date program information and course descriptions.

# Student Admissions and Selection

## Requirements for Full-Time Students

Admission to this college and to all other colleges in the State University of New York system is based on the qualifications of applicants. Applicants are reviewed without regard to race, color, creed, sex, age, national origin, handicap or marital status. In accordance with Section 504 of the Federal Rehabilitation Act of 1973, as amended, State Laws, and the Governor's Executive Order 40, the State University of New York does not discriminate against handicapped persons in the recruitment of students, the recruitment of an employment of faculty and staff, or in the operation of any of its programs and activities.

To be eligible for admission to Cobleskill Ag & Tech and the John Deere TECH concentration, a candidate must submit a SUNY application and satisfactorily meet the following requirements:

- Graduate from a fully accredited and approved high school or qualify for a High School Equivalency Diploma.
- Submit an official high school transcript.
- It is strongly recommended that applicants for admission submit scores from either the College Entrance Examination Board Scholastic Aptitude Test (SAT) or the American College Test (ACT).
- Candidates who have previously attended another higher education institution must submit an official transcript showing all attempted courses.
- Secure a John Deere Dealer Sponsorship.
- Following acceptance to a program and payment of deposits, a medical report form will be provided for the candidate's completion.

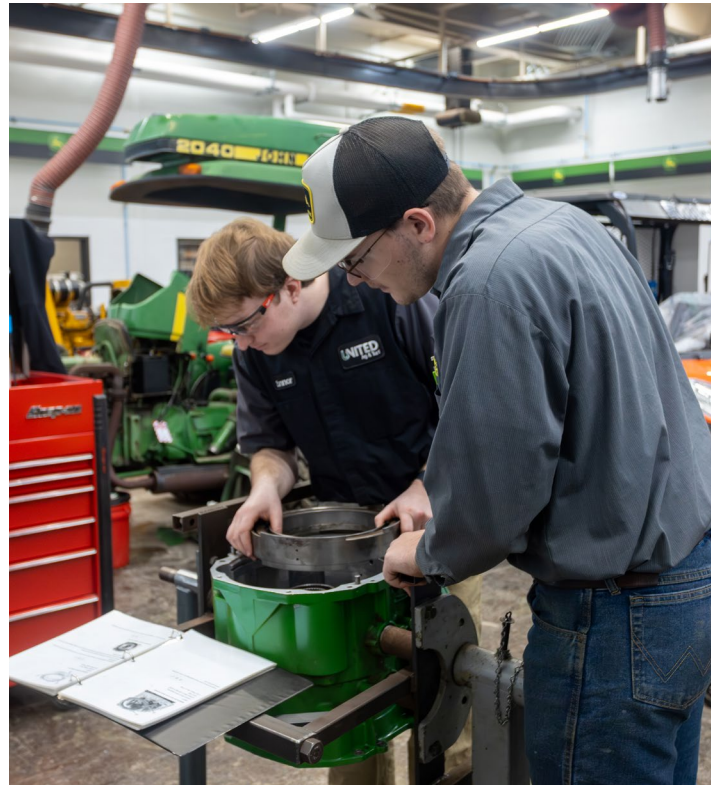

.....

Candidates are encouraged to include in their high school programs as many college preparatory courses as possible. Vocational agricultural courses are desirable prerequisites for admission in agriculture curricula. Applicants with a strong academic background have an advantage over those who have completed less rigorous high school programs. At Cobleskill Ag & Tech, admission requirements vary among the curricula, depending on the ratio of applications to openings.

.....

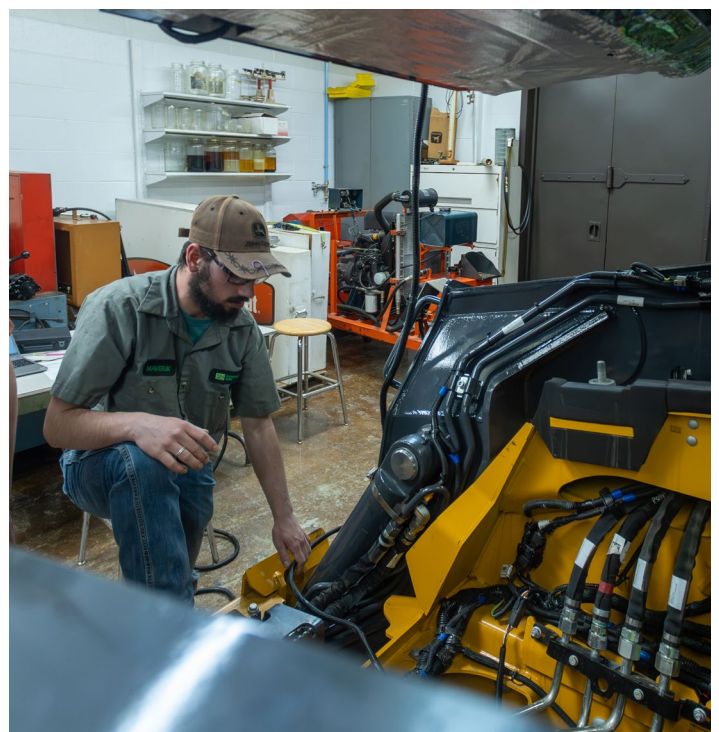

# Application Procedure



## Visit Campus

Schedule an on-campus visit and come see what immersive learning looks like!



## Apply to SUNY Cobleskill Ag & Tech

Submit your application online via the Common Application or the SUNY Application.



## Apply to the John Deere TECH Program

Fill out the John Deere Tech Program application online.



## Secure Your Sponsorship

Talk to a John Deere Dealer directly, or contact our John Deere TECH Program Coordinator for assistance.



## Submit Your Deposit

Once you've been accepted, pay your deposit to confirm your enrollment!



## Complete Final Paperwork

Finish any dealership paperwork and the sponsor form.



## Sponsor Approval

Applicants must complete an interview and secure approval from a sponsor. The applicant is responsible for locating a sponsor. Applicants should take the enclosed Dealer Approval Form to a potential sponsor, who is to complete the approval form and return it to the John Deere TECH Coordinator. The student should contact the John Deere TECH Coordinator who can assist the student in obtaining a sponsor.

## Eligible Dealer Locations

John Deere equipment dealers located in the following states are eligible to sponsor students at SUNY Cobleskill Ag & Tech:

Connecticut	Massachusetts	Pennsylvania
Delaware	New Hampshire	Rhode Island
Maine	New Jersey	Vermont
Maryland	New York	West Virginia

Students can contact a local John Deere dealer to see if the dealer is interested in sponsoring a student. Students can also contact the Cobleskill Ag & Tech Office of Admissions, the John Deere Coordinator, or visit [dealerlocator.deere.com](http://dealerlocator.deere.com) for a list of approved John Deere dealers seeking a student to sponsor.

## Scholarships

### SUNY Destination Scholarship

Available to all out of state students.

### John Deere TECH Scholarship

This is an academic- and internship-based scholarship available to all John Deere TECH students who meet the following criteria: 30 Credits, 2.85 GPA, and have a positive work experience performance review.

### George Henry & Ingrid L. Shepard Scholarship

Available to a John Deere TECH student with a minimum GPA of 3.0.

### SUNY Tuition Match

Tuition matching is available to certain out-of-state residents. Visit [www.suny.edu/smartrack/tuition-match](http://www.suny.edu/smartrack/tuition-match) to learn more.

### Contact:

Office of Admissions

SUNY Cobleskill Ag & Tech

518-255-5525

518-255-6769 (fax)

[cobleskill.edu](http://cobleskill.edu)

[admissions@cobleskill.edu](mailto:admissions@cobleskill.edu)

Chris Smith

John Deere TECH Program Coordinator

SUNY Cobleskill Ag & Tech

518-255-5694

[smithcr@cobleskill.edu](mailto:smithcr@cobleskill.edu)

## College Cost

	Full-Time / Semester	Full-Time / Year
New York State Resident Tuition	\$3,535	\$7,070
Out-of-State Resident Tuition	\$8,700	\$17,400
Comprehensive Fees*	\$849	\$1,698
Room - Double occupancy*	\$4,826	\$9,652
Meal Plan - On Campus Unlimited*	\$3,690	\$7,380
<b>Subtotal</b> (New York State Resident)	<b>\$12,900</b>	<b>\$25,800</b>
<b>Subtotal</b> (Out-of-State Resident)	<b>\$18,065</b>	<b>\$36,130</b>

\* All costs are subject to change. A list of mandatory (comprehensive) and voluntary fees can be found on the Cobleskill Ag & Tech website at [cobleskill.edu](http://cobleskill.edu).

The material in this packet is intended solely for information purposes. Cobleskill Ag & Tech reserves the right to make changes in curricula, rules and fees whenever such changes are deemed necessary. The announcements in this material are subject to change without notice, and may not be regarded as binding obligations on the institution of the State of New York.





## Student Sponsor Approval

Directions for the Student: Please fill in the form and give it to the prospective sponsoring dealer to complete and mail in to SUNY Cobleskill Ag & Tech.

Student's Name: \_\_\_\_\_

Street Address: \_\_\_\_\_

City, State, Zip: \_\_\_\_\_

Cell Phone: \_\_\_\_\_

Home Phone: \_\_\_\_\_

E-mail address: \_\_\_\_\_

### DEALER COMPLETE SECTION BELOW

I agree to provide sponsorship and abide by all dealership responsibilities for the above student in the John Deere TECH Program at SUNY Cobleskill Ag & Tech.

Dealership: \_\_\_\_\_

Street Address: \_\_\_\_\_

City, State, Zip: \_\_\_\_\_

Phone Number: \_\_\_\_\_

E-mail address: \_\_\_\_\_

Authorizing Representative: \_\_\_\_\_

Dealership Supervisor: \_\_\_\_\_ Phone: \_\_\_\_\_

Dealership Supervisor E-mail address: \_\_\_\_\_

Student XID: \_\_\_\_\_

(Each student needs their own individual account prior to the start of classes).

Complete this form and return to:  
Chris Smith, John Deere TECH Program Coordinator  
Scan / Email: smithcr@cobleskill.edu







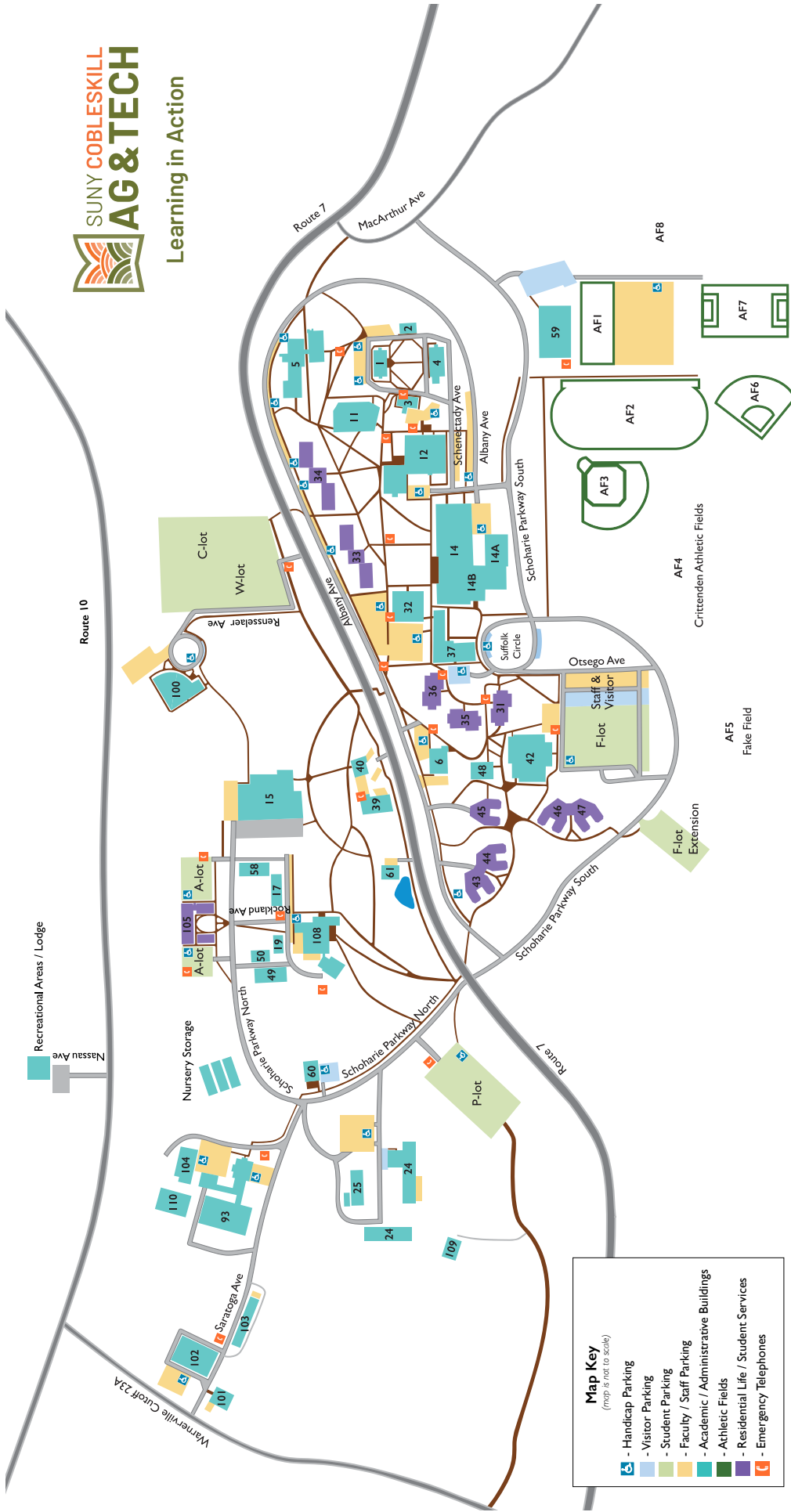

- |   |   |   |                                  |
|---|---|---|----------------------------------|
| Alumni Commons (105)                      | Center for Agriculture & Natural Resources (108)    | Johnson Hall / University Police (39)     | Warner / Holmes Hall (5)         |
| Alumni Hall (3)                           | Center for Environmental Science & Technology (104) | Knapp Hall (37)                           | Wheeler Hall (12)                |
| Animal Science A / Canine (19)            | Champlin Hall (42)                                  | Kniskern House (40)                       | Wisting Hall (34)                |
| Animal Science B / Livestock (50)         | Cobleskill Child Care Center (100)                  | Mackey Service Building / Facilities (24) | <b>ATHLETIC FIELDS</b>           |
| Animal Science C / Livestock (49)         | Curtis Mott Hall (15)                               | Neal Robbins Field House (59)             | Crittenden Athletic Fields (AF4) |
| Animal Science D / Canine Kennels (103)   | Dairy Complex (93)                                  | Old Gym (4)                               | Fake Field (AF5)                 |
| Animal Science E / Equine Classroom (101) | Davis Hall (43)                                     | Parsons Hall (44)                         | Crittenden Athletic Fields       |
| Animal Science F / Equine Arena (102)     | Dix Hall (35)                                       | Pearson Hall (31)                         | Fake Field                       |
| Beard Wellness Center (6)                 | Draper Hall (36)                                    | Porter Hall (45)                          |                                  |
| Beef Cattle Barn (109)                    | Fake Hall (47)                                      | Prentice Hall (32)                        | Lacrosse / Soccer Field (AF7)    |
| Bouck Hall (14)                           | Farm / Horticulture Machinery (17)                  | TenEyck Hall (46)                         | Men's Baseball Field (AF3)       |
| Bouck Pool (14A)                          | Frisbie Hall (1)                                    | Turf Grass (58)                           | Practice Field (AF8)             |
| Bouck Atrium / Ballroom (14B)             | Heifer Barn (110)                                   | VanWagenen Library (11)                   | Tennis Courts (AF1)              |
| Brickyard Point (48)                      | Hodder Garage (61)                                  | Vroman Hall (33)                          | Track (AF2)                      |
| Carriage House (60)                       | Home Economics Hall (2)                             | Warehouse / Shipping & Receiving (25)     | Women's Softball Field (AF6)     |



**JOHN DEERE**

---

**TECH PROGRAM**